



COMBI & TWIN ADAPTERS

- European Brass, DW (4MS) quality for use in drinking water installations.



TECHNICAL SHEET COMBI & TWIN ADAPTERS

PRODUCT DESCRIPTION

Adapters for the COMBI and TWIN range of valves, includes flat joint.

PRODUCT SCOPE

It allows the valve outlet to be transformed to different sizes.

GENERAL DIMENSIONS, PRESSURE AND TEMPERATURE

Code	Size	A (mm)	H (mm)	PN (bar)	Temp.(°C)
COMBI89	3/8FX3/4M	26	21	16	0 to 95
COMBI89U	3/8FX3/4M	26	21	16	0 to 95
COMBI88	3/8FX1/2M	21	22	16	0 to 95
COMBI88U	3/8FX1/2M	21	22	16	0 to 95
COMBI87U	1/2FX3/4M	26	20	16	0 to 95

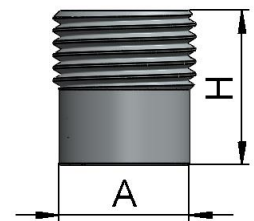

Temperature range excludes freezing.

Item	Component	Material	Finishing
1	Flat joint	EPDM	-
2	Body	Brass CW617N	Chrome plated

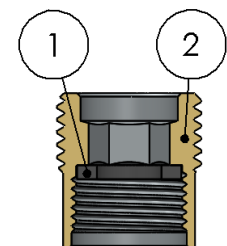



TECHNICAL DATA

Compatibility with fluids

Fluid	Compatibility
Drinking water and domestic hot water	Excellent

For any other fluid, please contact Arco technical service.

INSTALLATION AND OPERATION INSTRUCTIONS

Before performing any action, the water supply to the installation should be shut off. Make sure there is no dirt or foreign objects in the connection to the network. Apply the appropriate sealing material to the inlet thread of the valve. The valve should be installed with a suitable tool, preferably with a wrench to hold the body. The tool should act on the flat surfaces of the valve body to avoid deforming this area due to excessive pressure from the tool. Restore the water supply and check the tightness of all connections before fixing the valve to service.



All products have an environmental impact during its life cycle, even once retired. All the components of this product can be recycled. Once the use is over, leave the valve in any recycling green point. Válvulas Arco reserves the right to change the product or any of its technical specifications without prior notice.

FT02100ING – Edition 2024-12